

# Castles



Learn  
from  
yesterday

Hope  
for  
today

Live  
for  
today



OFFERS IN EXCESS OF  
**£210,000**  
**Church Street**  
Edmonton, N9 9HL

## PROPERTY SUMMARY

A one bedroom ground floor flat situated within 1/2 mile of Edmonton Green with it's shops and transport links. The property comprises of Bedroom, bathroom, Reception and kitchen It also has features to include, 148 year lease, communal garden and double glazing.

148 year lease

Ground Rent: £120.00 Per Year

Service Charge: £1,435.00



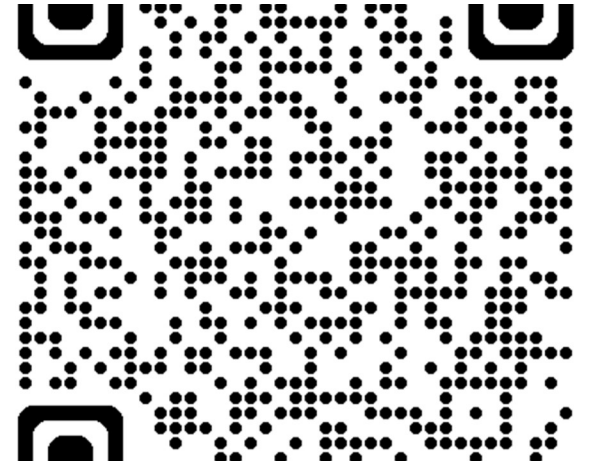
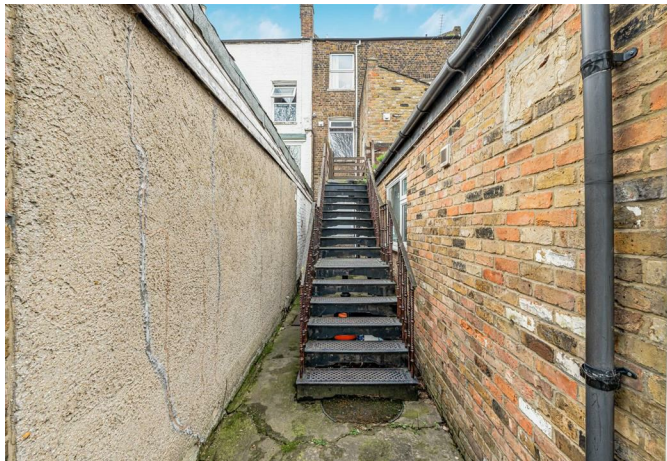

Church Street, Edmonton, N9

Approximate Gross Internal Area = 434 sq ft / 40.2 sq m

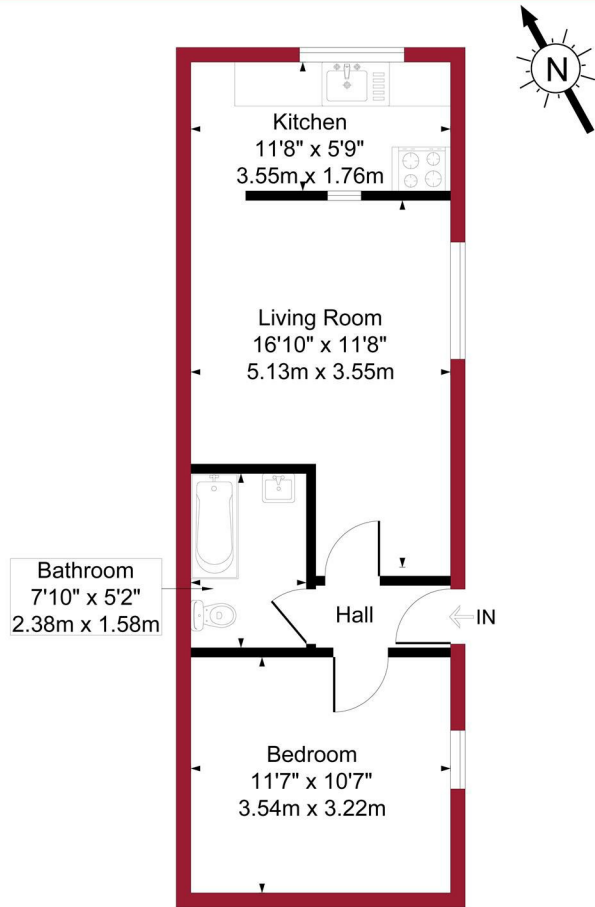

Lower Ground Floor

For a guide to the area please scan this code for more information

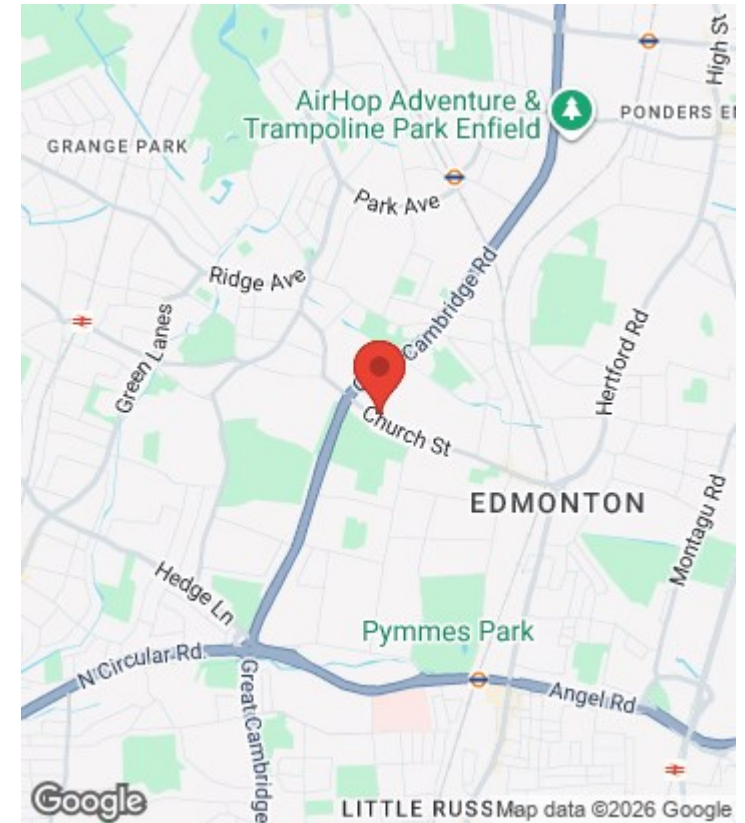
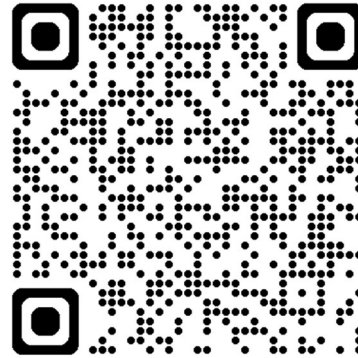

Flat

Leasehold

**Council:** Enfield

**Council Tax Band:** B

Agents Note: Whilst every care has been taken to prepare these particulars, they are for guidance purposes only. All measurements are approximate and are for general guidance purposes only and whilst every care has been taken to ensure their accuracy, they should not be relied upon and potential buyers/tenants are advised to recheck the measurements



**OFFICE ADDRESS**

438 Hertford Road  
Edmonton  
London  
N9 8AB

**OFFICE DETAILS**

020 8804 8123  
edmonton@castles.london  
<https://www.castles.london/>

