



**Nags Head Road, EN3 7AA**

£285,000

Leasehold

**Castles**







## Nags Head Road, EN3 7AA

A well presented and larger than usual 2 double bedroom first floor converted maisonette with own entrance and garage to rear. Located in the Ponders End area close to Southbury train station, shops and bus routes. An internal viewing is recommended. Features include: own entrance, 2 double spacious bedrooms, modern kitchen and bathroom fittings, gas central heating, double glazing, lease to be extended by seller on completion (terms to be confirmed by seller solicitors), viewing recommended,

EPC Rating: D  
Current: 67 Potential: 71  
Council Tax Band: C

Lease :  
Current lease is 63 years  
Seller to extend lease to 153 years on completion of the sale – tbc by seller solicitors.  
Ground rent : currently £100 p/a  
Service charges: N/A

**£285,000 Leasehold**

# Castles

020 8804 8000  
enfield@castles.london





APPROXIMATE GROSS INTERNAL AREA  
68.13 sqm / 733.34 sqft

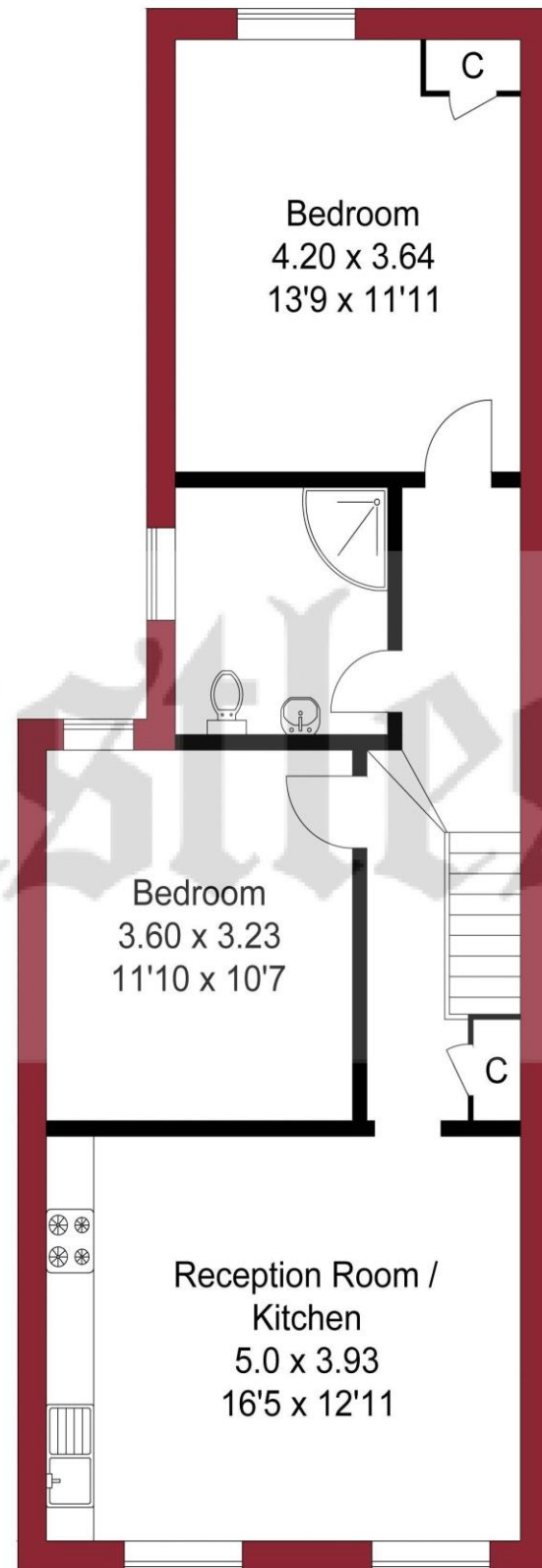

GROUND FLOOR  
ENTRANCE

FIRST FLOOR

THIS PLAN IS FOR ILLUSTRATION ONLY AND MAY NOT BE  
REPRESENTATIVE OF THE PROPERTY

### An overview of Enfield

Enfield boasts a proud and distinguished history, home to several country houses and ancient monuments, the area also hosts a notable contingent of famous residents both past and present.

With affordable homes and a safe, green environment, Enfield attracts many buyers pleasantly surprised by the good value of property compared to some of the more pricey neighbouring boroughs.

On the lush, green perimeter of London, Enfield has excellent transport links with a quick and easy train journey into the City and West End.

There are a range of activities to keep residents busy in the borough with seven bustling shopping areas, 900 hectares of parks, three golf clubs, and numerous cinemas, theatres and museums. There is a diverse community residing in the area.

Notable for its range of great schools, vast green spaces and bustling retail centres, as well as good transport links to the rest of the city, Enfield is undoubtedly a thriving place to live and work and proves an excellent choice for first time buyers, families, young professionals and property investors alike."

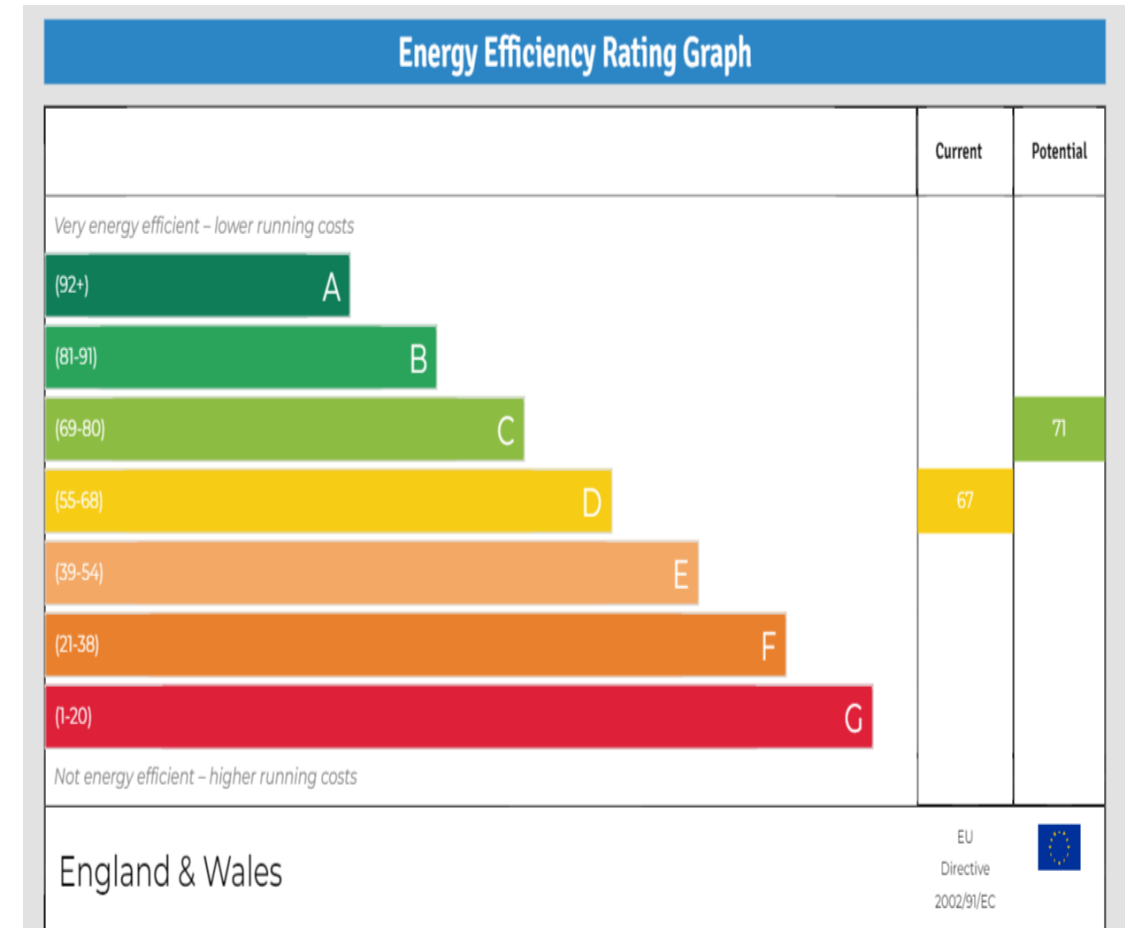

243-245 Hertford Road  
Enfield, EN3 5JJ  
0208 804 8000  
enfield@castles.london  
www.castles.london

All details including floorplans are for representation purposes only and do not constitute a contract or warranty. Whilst every effort is made to ensure accuracy of descriptions and measurements, no responsibility is taken for errors, omissions and misstatements.

rightmove  
find your happy

Zoopa  
Smarter property search

PrimeLocation  
Find the home you deserve



A free, fair and independent service for buyers, sellers, tenants and landlords of property in the UK.

