



**Nursery Close, EN3 5JZ**

O.I.E.O. £520,000

Freehold

**Castles**







## Nursery Close, EN3 5JZ

An extended bay fronted 4 bedroom mid terraced family house located in a quiet cul-de-sac off Addison Road within approx 0.5m of Brimsdown train station (London Liverpool Street and Tottenham Hale) and close to local schools. The property has been extended to the rear with a loft conversion and offers spacious accommodation and is in good decorative order. Viewing is recommended. Features include:- front off street parking for 2 cars, double glazing, gas central heating, through lounge, extended modern fitted kitchen, first floor family bathroom, south facing rear garden, loft conversion, quiet cul-de-sac location.

EPC Rating: D  
Current: 60 Potential: 83

Council Tax Band: D

O.I.E.O. £520,000 Freehold

# Castles

020 8804 8000  
enfield@castles.london





APPROXIMATE GROSS INTERNAL AREA  
114.04 sqm / 1227.51 sqft

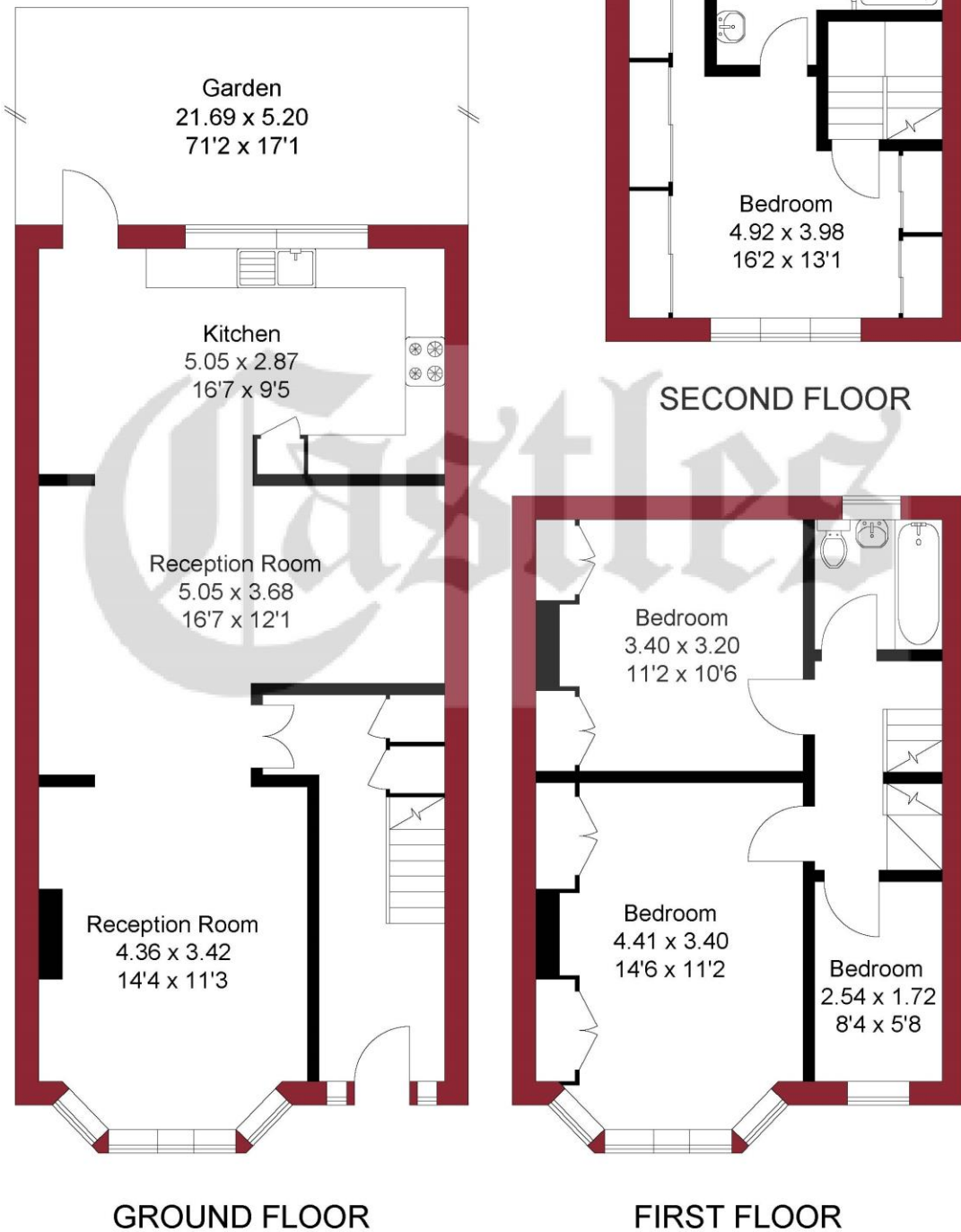

THIS PLAN IS FOR ILLUSTRATION ONLY AND MAY NOT BE REPRESENTATIVE OF THE PROPERTY

### An overview of Enfield

Enfield boasts a proud and distinguished history, home to several country houses and ancient monuments, the area also hosts a notable contingent of famous residents both past and present.

With affordable homes and a safe, green environment, Enfield attracts many buyers pleasantly surprised by the good value of property compared to some of the more pricey neighbouring boroughs.

On the lush, green perimeter of London, Enfield has excellent transport links with a quick and easy train journey into the City and West End.

There are a range of activities to keep residents busy in the borough with seven bustling shopping areas, 900 hectares of parks, three golf clubs, and numerous cinemas, theatres and museums. There is a diverse community residing in the area.

Notable for its range of great schools, vast green spaces and bustling retail centres, as well as good transport links to the rest of the city, Enfield is undoubtedly a thriving place to live and work and proves an excellent choice for first time buyers, families, young professionals and property investors alike."

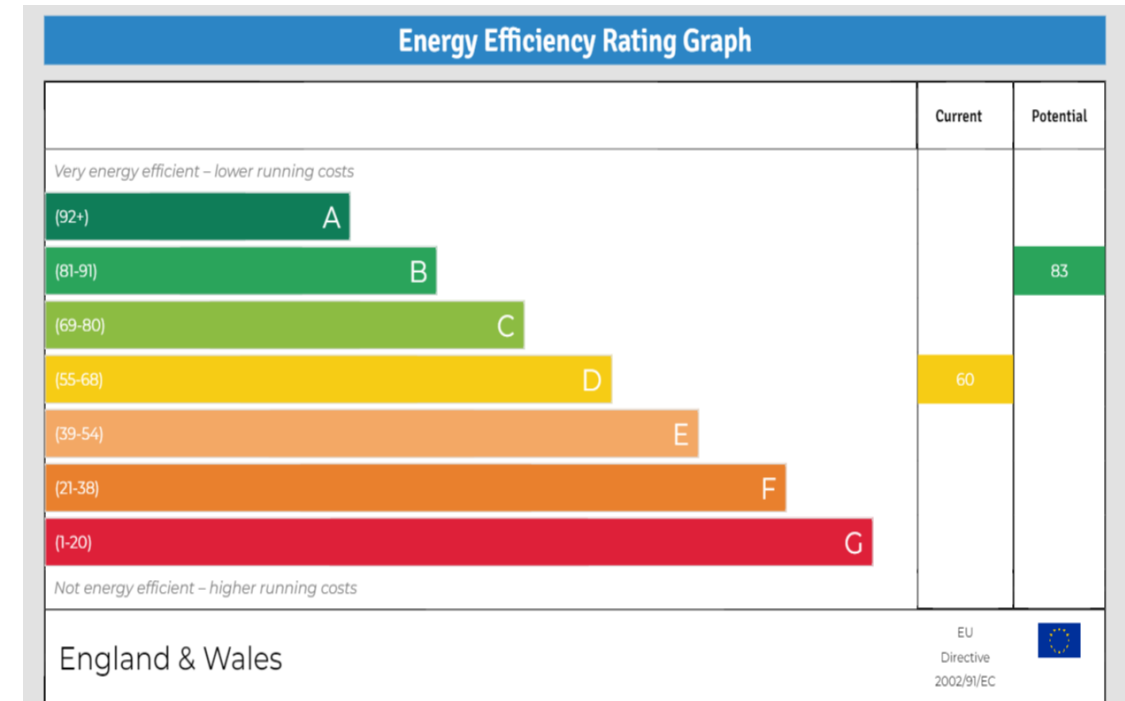

243-245 Hertford Road  
Enfield, EN3 5JJ  
0208 804 8000  
enfield@castles.london  
www.castles.london

All details including floorplans are for representation purposes only and do not constitute a contract or warranty. Whilst every effort is made to ensure accuracy of descriptions and measurements, no responsibility is taken for errors, omissions and misstatements.

rightmove find your happy  
Zoopla Smarter property search  
PrimeLocation Find the home you deserve  
The Property Ombudsman A free, fair and independent service for buyers, sellers, tenants and landlords of property in the UK.  
NAEA National Association of Estate Agents